

GYPSE

TRADITIONAL
BALUSTRADE



Photography: V. Bigeard

IMAGINE WHAT'S NEXT

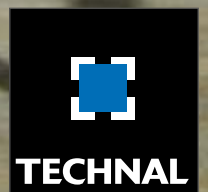



GYPSE

/ A BALUSTRADING SYSTEM WITH COUNTLESS OPPORTUNITIES AND MINIMALIST LINES

GYPSE, A LEADING DESIGN

With an aesthetic “metal effect” and design both minimalist and scalable, Gypse balustrading is a true building. Discrete or differentiating elements, Technal’s balustrading is suited to diverse project situations – facades, atria, etc.

The variety of styles and finishes within the range meets the needs of all market sectors, whether new build or renovation.

GYPSE, TWO PRINCIPLES FOR ONE SYSTEM

There are two types of construction:

- Double post
- Single post

The balustrading, straight or raked... meets the most demanding of designs and plays on a combination of components and the mix of material: stainless steel, wood, glass and composite panel.

With the double-post, Gypse is aimed at architectural projects where balustrading plays an active role in the graphics of the façade or atrium.

With the single-post, the balustrading is suited to the more traditional residential renovation market.

The Gypse system carries several Technal patents ensuring full compliance with standards and regulations.



Architect: A. Capelle
Photography: G. Tordeman

GYPSE

/ TRADITIONAL SINGLE
POST BALUSTRADING

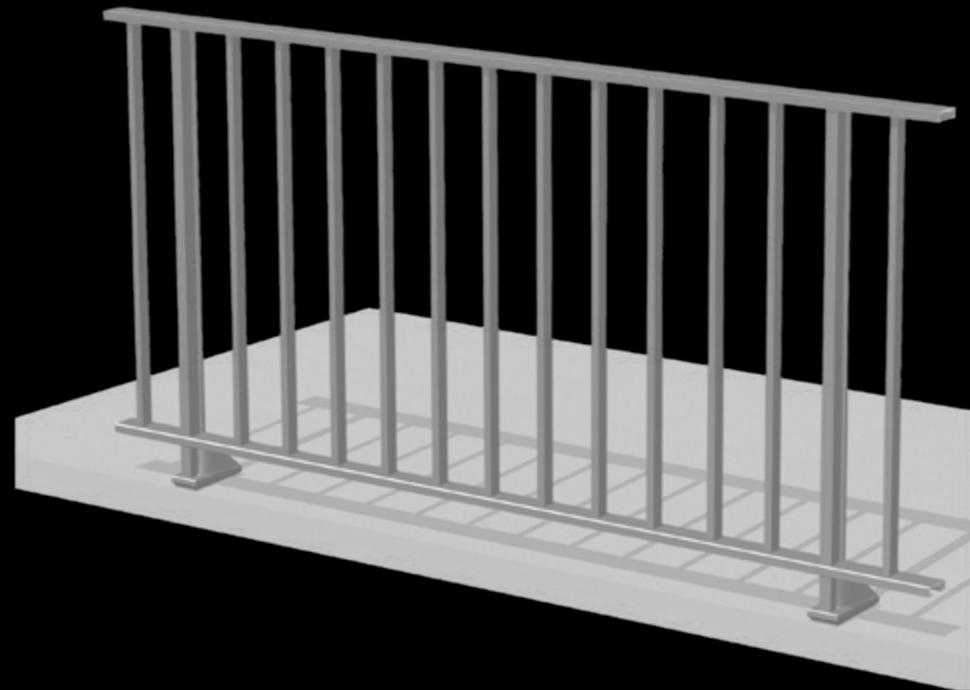

KEY FEATURES AND INNOVATIONS

REFINED AESTHETICS

- Simple design without visible fixing.
- A single symmetrical post 50 x 24 mm means a reversible appearance when used for straight runs and corners.
- Handrail options are rectangular 27 x 65 mm, 35 x 65 mm, 30 x 85 mm; round 50-mm diameter; or supports for timber handrails.
- Round, 30-mm diameter or rectangular midrails and bottom rails hold infills (sheet, glass, or composite panels).
- Discreet handrail and midrail brackets
- Installation options: slab, slab nose, front-face panel, between walls and base wall.
- Base plates with one or two fixing points.

INFILLS AND DESIGN STYLES

- Infills can be positioned on the outside face, inside face, or between the posts.
- Wide variety of infill options: vertical railings and running band beneath midrail, and running band beneath midrail with St Andrew's cross or "steamship" versions; glass, sheet metal, etc.
- Mix of materials: aluminum, wood, glass and composite panel.
- Also for separating balconies, swimming pool safety barriers.

PERFORMANCE

- Standard compliance: 78 PV testing available (meets latest standards for horizontal loads and glass infills).
- Several patents.

RANGE OF INFILLS



Vertical rails beneath handrail

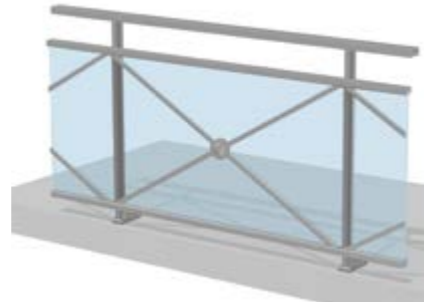

Running band beneath midrail with St Andrew's cross



Vertical rails beneath midrail

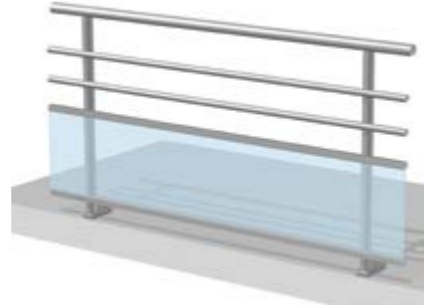

'Steamship' running band

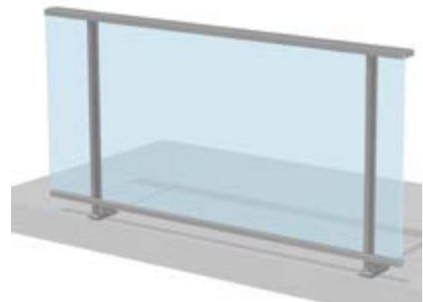

Glass infill beneath handrail



On base wall

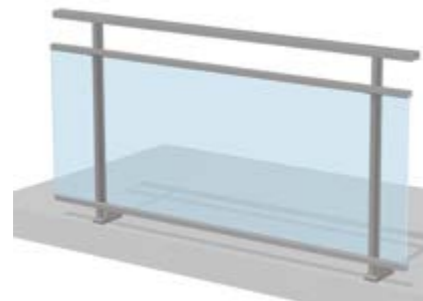

Running band beneath midrail with glass infill



Architect: R. Morel
Photography: E. Salliet



CORNER RETURNS, LATERAL BRACKET

- A unique post to ensure 90° returns and straight sections.
- Wallmount bracket accommodates angle $\pm 10^\circ$ and dimension variation between walls ± 15 mm



RAKED SECTIONS

- Raked option from 0° to 38°.
- Bracket for handrail and mid rail is articulated to create corners.
- Predrilled midrail for raking 27° to 38°.
- Applications and models for straight balustrading apply to raked versions.

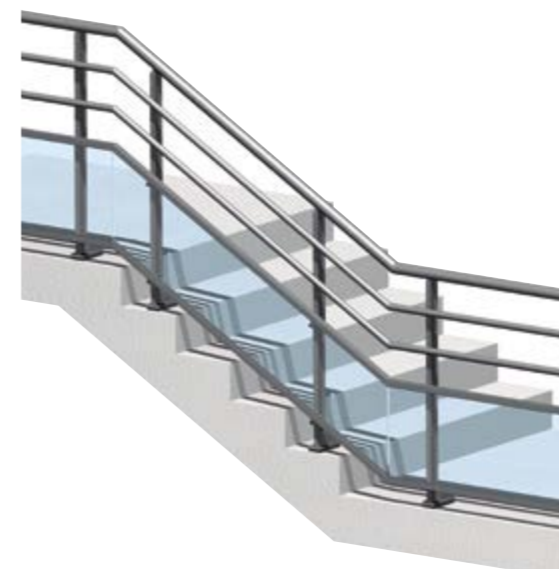

HANDRAILS AND BASEPLATES

HANDRAILS WITH END CAPS



Round 50-mm diameter handrail



Clipped rectangular 35 x 65-mm handrail

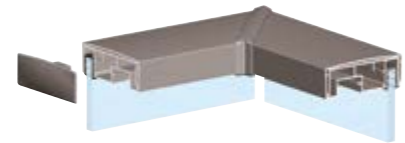

Clipped rectangular 30 x 85-mm handrail



Clipped rectangular 21 x 60-mm handrail



Clipped rectangular 36 x 65-mm handrail

BASEPLATES

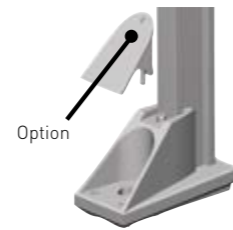

Slab-fixed
1-point fixing



Slab-fixed
2-point fixing

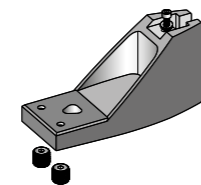

Slab-fixed infill in front of slab

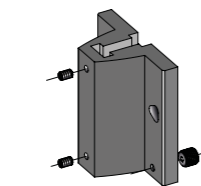

Slab nose



On base wall





SECTIONS

VERTICAL RAILINGS
BETWEEN POSTS

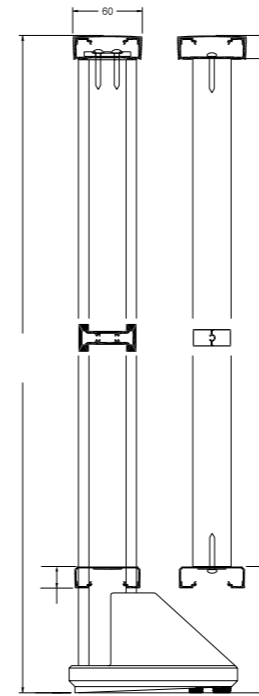

VERTICAL RAILING
ON FACE OF POSTS

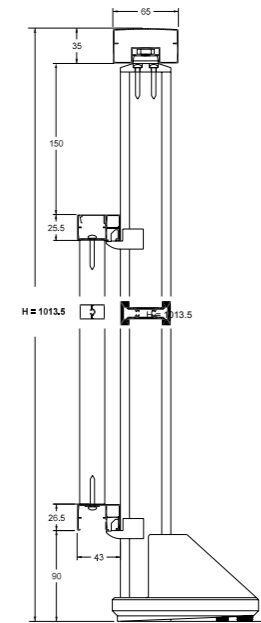

RUNNING BAND
ST ANDREW'S CROSS

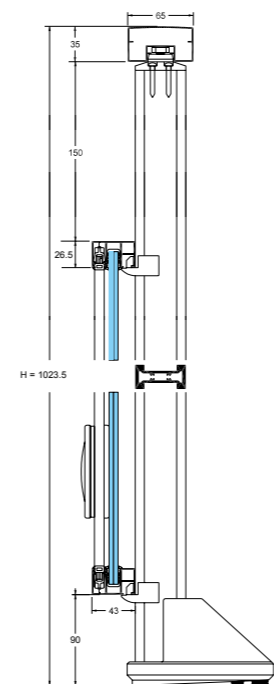

RUNNING BAND
'STEAMSHIP'

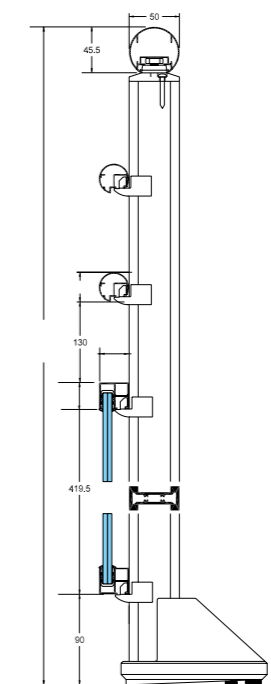

APPLICATIONS

EXAMPLES OF STRAIGHT OR RAKED BALUSTRADING

STRAIGHT - RUNNING BAND

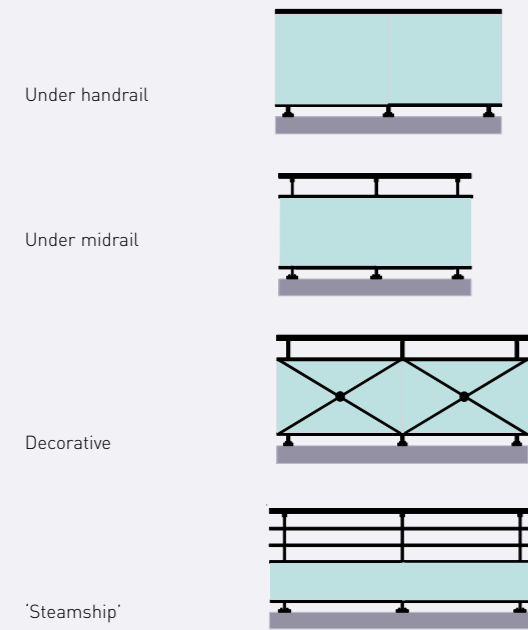

RAKED

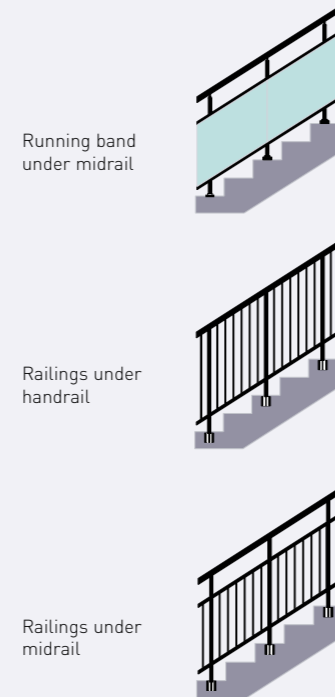

STRAIGHT - VERTICAL RAILINGS

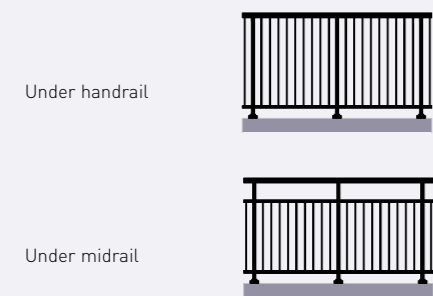

PERFORMANCE

LIMITS = MAXIMUM DISTANCE BETWEEN POSTS

	Private		Public	
	Infill panels (glass, sheet metal)	Railings	Infill panels (glass, sheet metal)	Railings
	1600 mm	1599 mm	985 mm	984 mm
	1800 mm	1800 mm	1800 mm	1800 mm
	1600 mm	1599 mm	985 mm	984 mm
	1600 mm	1540 mm	985 mm	980 mm

COMPLIANCE

78 tests carried out on 41 applications in public and private spaces and to the current standard NFP 06-111-2 /A1 Eurocode for horizontal loads and validation by CEBTP for all running band balustrading applications, to DTU39 for glazed balustrading systems.

MATERIALS AND PARTS

As with all Technal systems only materials and components of the highest quality are used for minimum maintenance and long-term performance.

- Aluminium profiles are extruded from alloys 6060 Building compliant with EN 12020, EN 573-3, EN 515 and EN 775-1 to 9.
- Accessories are cast from Zamak 5 or AS13.
- Screws are stainless steel.

FINISHES AND COLOURS

A wide range of finishes is available to meet individual project requirements, complement existing buildings and offer additional design freedom for architects and specifiers:

- Anodised in accordance with EN 123 731: 2001.
- Stoved polyester powder coating in a wide colour range in accordance with "QUALICOAT".
- GYPSE is also available in painted finishes with Technal's exclusive colours for a stylish and contemporary look.

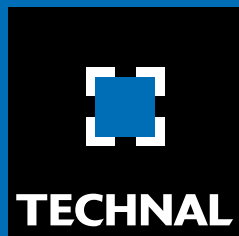

IMAGINE WHAT'S NEXT

270, rue Léon-Joulin
BP 63709 - 31037 Toulouse cedex 1
Tél. 05 61 31 28 28 - www.technal.com



By  Hydro