

SAPA GLAZED ELEMENTS

3086/3086 SX HIGH INSULATED WALL PARTITIONS

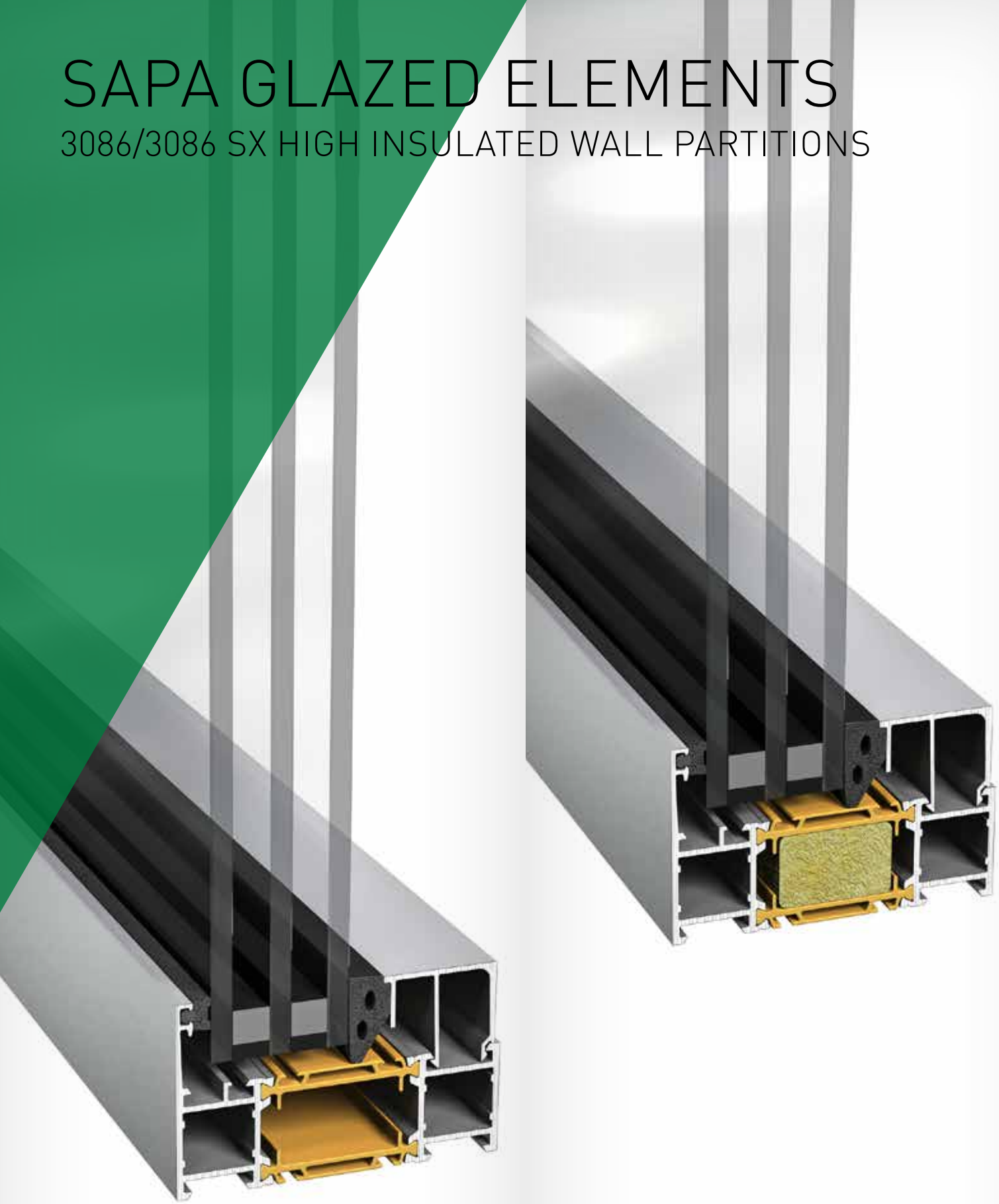

By  Hydro

Sapa Glazed Elements 3086/3086 SX

Glazed Elements 3086 and 3086 SX have 86 mm deep aluminium profiles. These have basic insulation, with 42 mm of glass fibre reinforced polyamide strips. For optimum energy performance, choose Glazed Element 3086 SX with Sapa Thermo N9 insulating strips in profiles.

Rebate for glass 20–56 (64) mm.

Glazing is carried out from the inside, using glazing beads. Outside and inside gaskets have straight edges to maximise the clear area of glass.

The system has single-panel ventilation/drainage, which means that each glass/infill panel is ventilated and drained independently. The system also has a two-stage seal, with the outer gasket acting as a rain stop, and the inner gasket acting as the main seal (air/water).

3086 is available in two insulation variants, Standard and SX.

Glazing is carried out from the inside.

Acoustic insulation

up to R_w 46 dB.

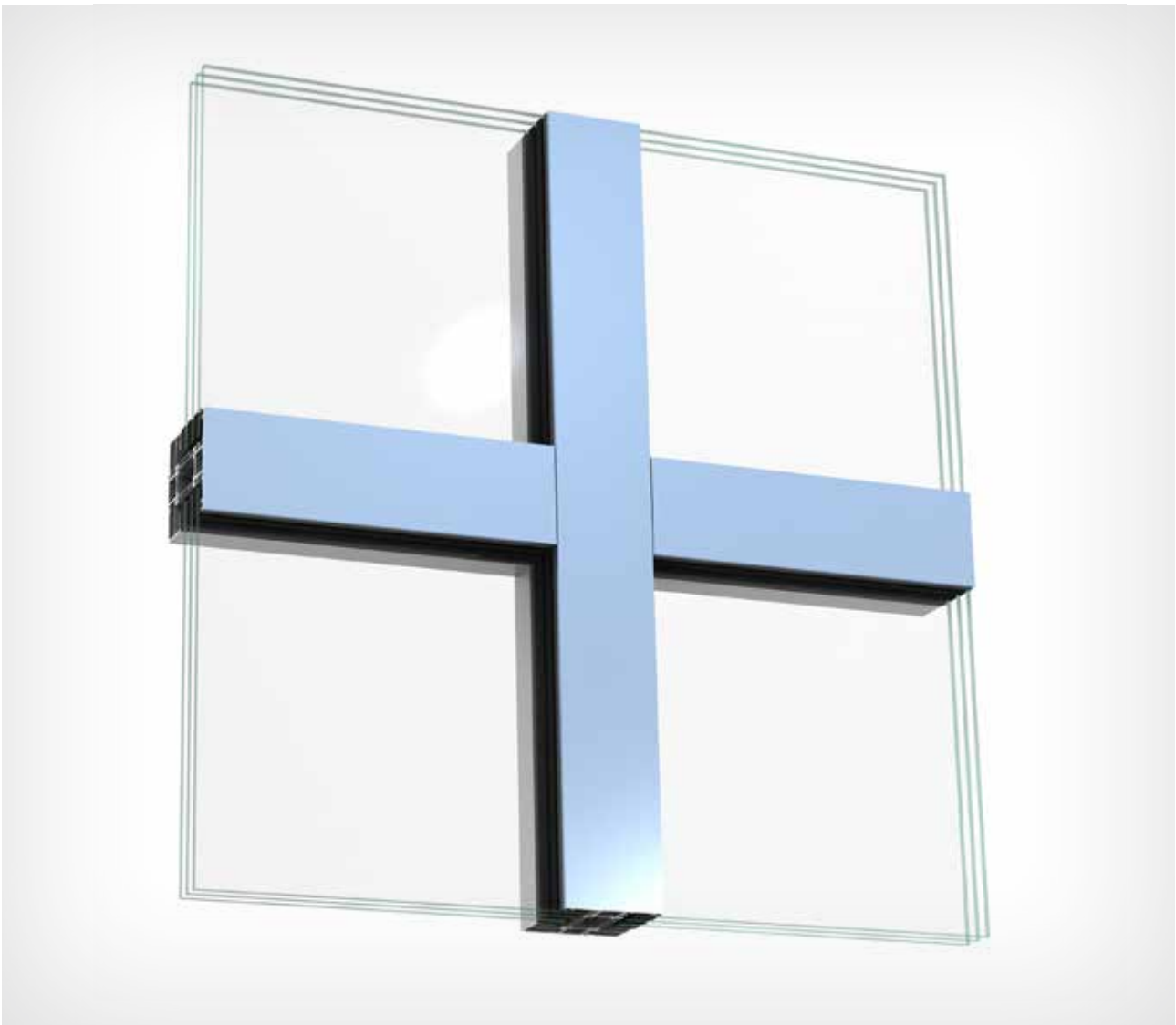

Glazed element 3086 powder coated

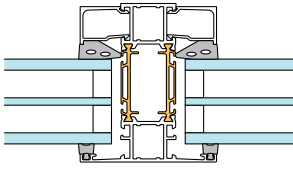

3086 insulated profiles

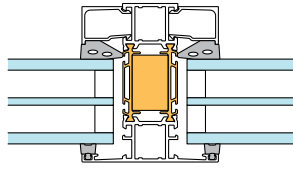

3086 SX super-insulated profiles

Constructed as a curtain wall, normally single-storey height between floor slabs and columns, glazed from the inside.

For even higher insulation 3086 is also available in PX-version. Read more about PX in Sapa Windows 1086, 1086 SX and 1086 PX.

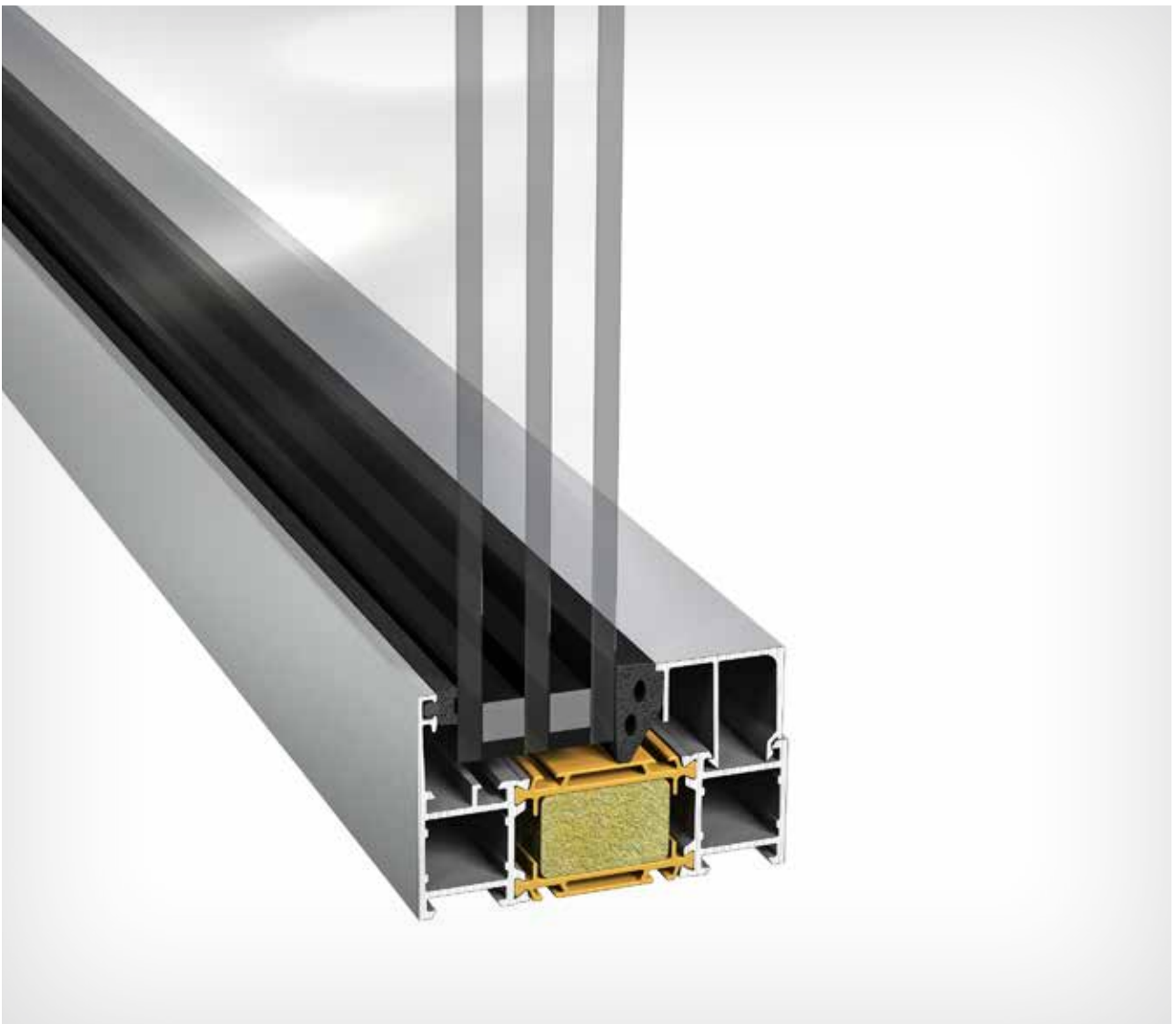

Sapa Glazed Elements 3086 SX

Glazed element 3086 profiles

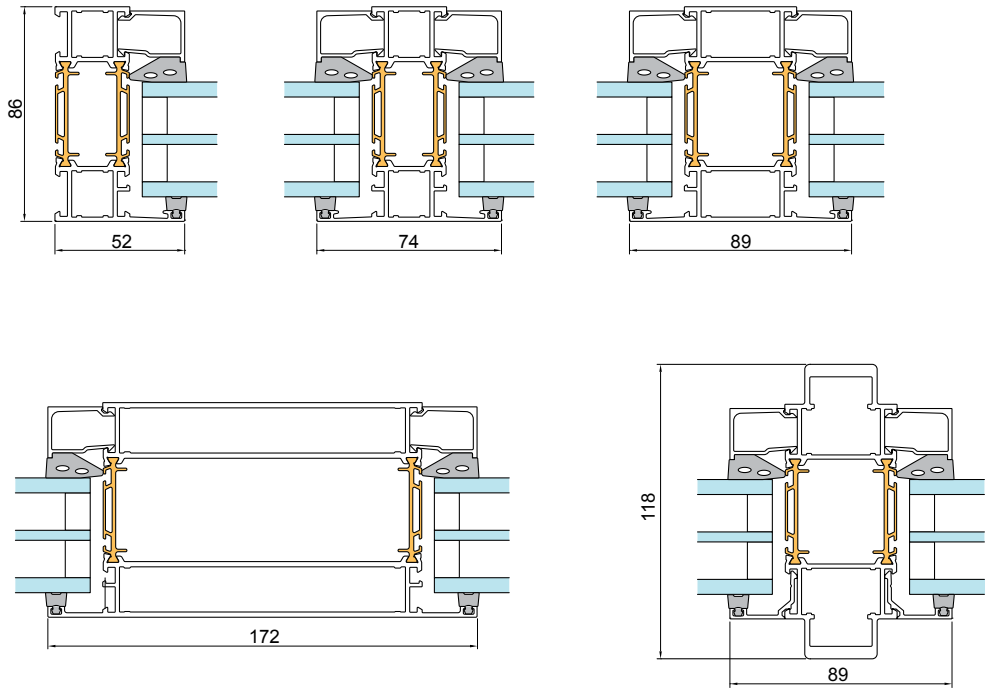

86 mm deep with integrated glazing beads on outside. Rebate for double- or triple-glazed unit.

Column profile 118 mm deep. Rebate for double- or triple-glazed unit.

Glazed element 3086 SX profiles

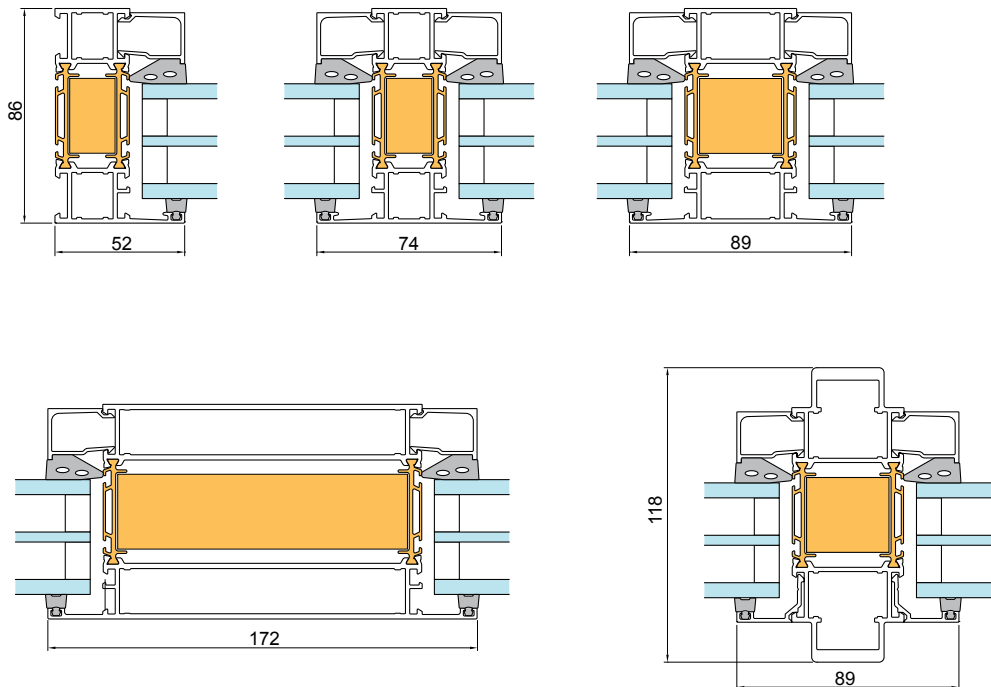

86 mm deep with integrated glazing beads on outside. SX specification has insulating strips of Sapa Thermo N9 in the profiles. Rebate for double- or triple-glazed unit.

Column profile 118 mm deep. Rebate for double- or triple-glazed unit.

Sapa Glazed Element 3086 SX, triple-glazed

Glass, U_g W/m²K (centre point). Spacer, warm edge.

Profile share	0.5	0.6	0.7	0.8	0.9	1.0
10%	0.66	0.75	0.84	0.93	1.0	1.1
15%	0.75	0.83	0.92	1.0	1.1	1.2
20%	0.83	0.91	0.99	1.1	1.1	1.2

Doors in 3086/3086 SX, see Doors.

Windows in 3086/3086 SX, see Windows.

3086/3086 SX insulated profiles

Profile depth	86–118 mm
Profile width	52–172 mm
Glass	double-glazed and triple-glazed: 20–64 mm
Full infill panel	Exterior surface of sheet metal/facade glazing, interior surface of sheet metal/board.
Fire protection class	EI 30, see Fire

Asymmetrically installed glass, integrated glazing bead

Glass thickness 20–64 mm

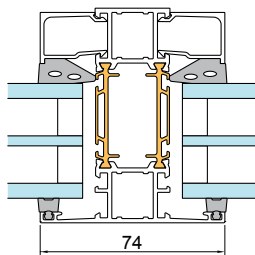

Symmetrically installed glass, design glazing bead

Glass thickness 32–42 mm

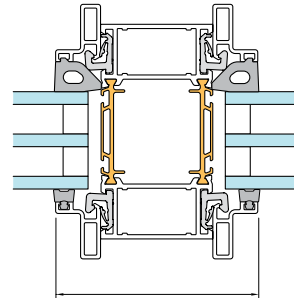

Glazed element 3086 with window 1086 and door 2086

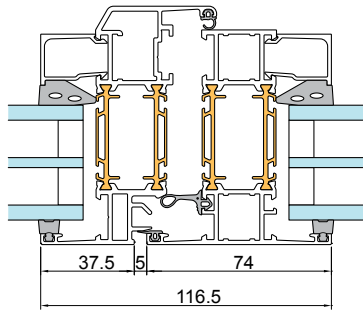

Sapa Window 1086

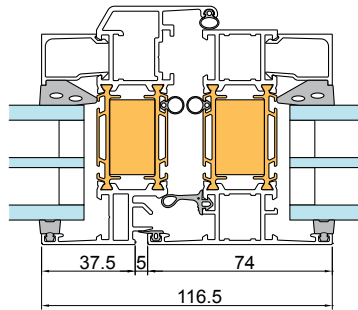

Sapa Window 1086 SX

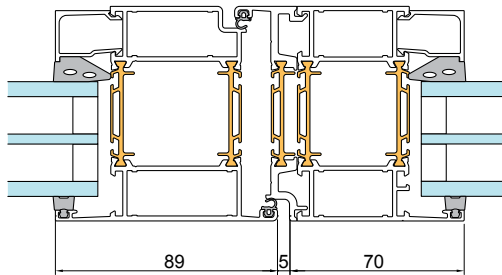

Sapa Door 2086 with narrow profile

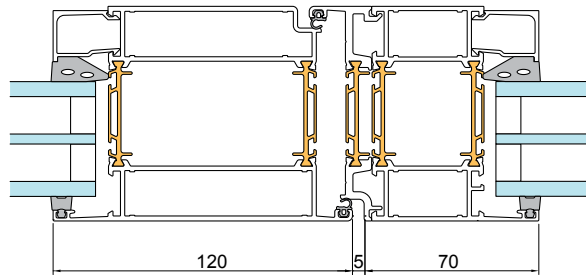

Sapa Door 2086 with module profile

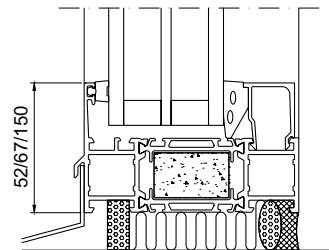
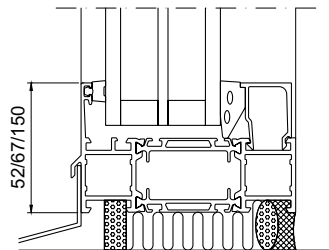
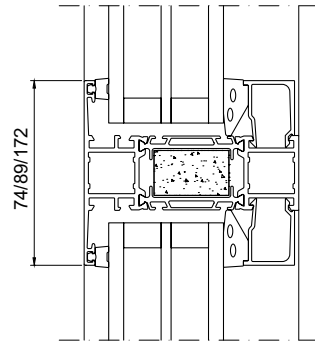
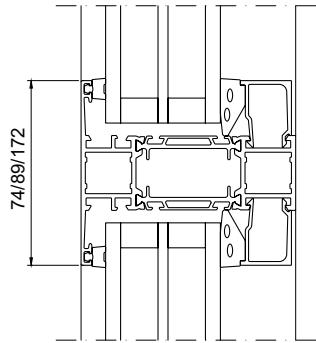
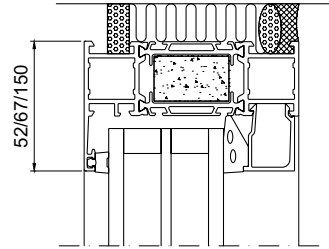
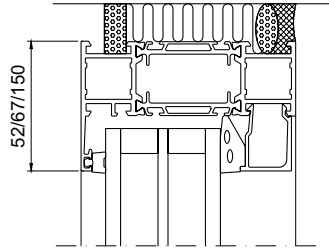

Glazed element 3086, examples of unclassified infill panels

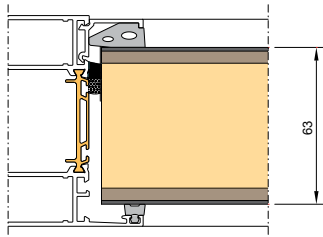

Example F2 infill panel
Max. thickness 63 mm

Infill panel F1

*U-value at centre point: as low as 0.54 W/m²K.
For areas with little mechanical impact,
such as high-level infill panels.*

- 1.5 mm aluminium sheet*
- max. 60 mm insulation*
- 1.5 mm aluminium sheet*

Infill panel F2

*U-value at centre point: as low as 0.61 W/m²K.
For areas with moderate mechanical impact,
such as low-level infill panels.*

- 1.5 mm aluminium sheet*
- 4.8 mm board*
- max. 50 mm insulation*
- 4.8 mm board*
- 1.5 mm aluminium sheet*

Infill panel F3

*U-value at centre point: as low as 0.61 W/m²K.
For areas with high mechanical impact from
outside.*

- 1.5 mm aluminium sheet*
- max. 50 mm insulation*
- 10 mm wood fibre board*
- 1.5 mm aluminium sheet*

Glass 3086, 3086 SX

Glazed element 3086 3086 SX

Glass thickness 20-64 mm

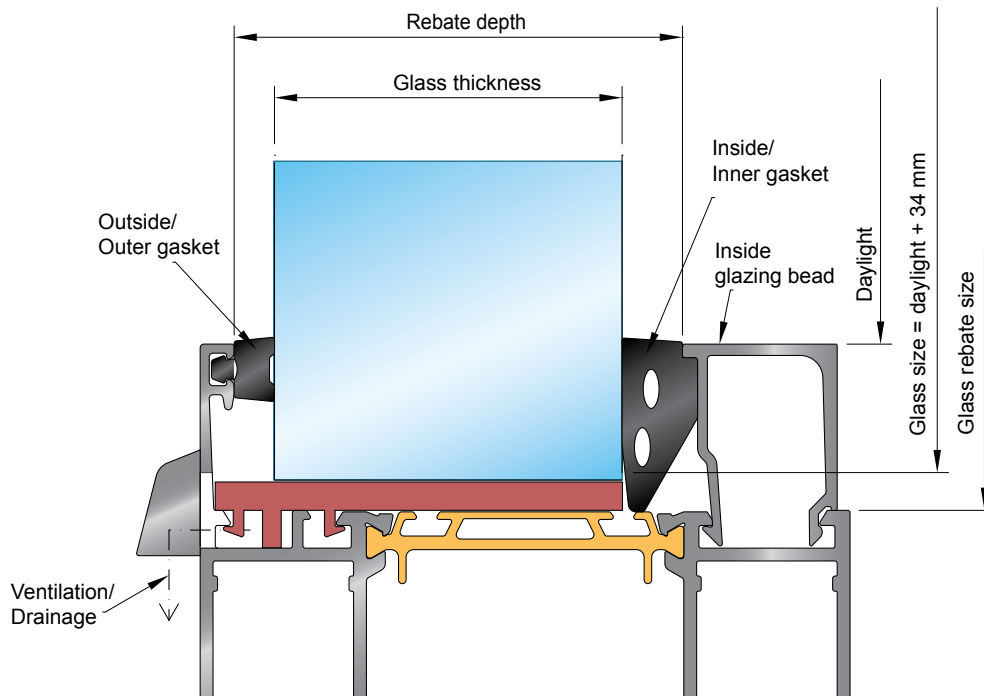

sapa:

By  **Hydro**

Hydro Building Systems, region North

Sweden

SE-574 81 Vetlanda
T +46 (0)383 942 00
E sapa.se@hydro.com

Norway

NO-2027 Kjeller
T +47 63 89 21 00
E sapa.no@hydro.com

Denmark

DK-8240 Risskov
T +45 8616 0019
E sapa.dk@hydro.com

Finland

FI-02180 Espoo
T +358 (0)9 867 82 80
E system.fi@hydro.com

Lithuania/Estonia/Latvia

LT-02244 Vilnius
T +370 (0)5 210 25 87
E sapa.lt@hydro.com

Poland

92-620 Łódź, Polska
T +48 (0)42 683 63 73
E sapa.pl@hydro.com

sapabuildingsystem.com