

SAPA SLIDING DOOR ARTLINE XL

EXCLUSIVE MINIMALIST DESIGN



sapa:

By  Hydro

Sapa Artline XL Sliding Door

The Artline sliding door is constructed from insulated aluminium profiles and is specially designed to maximise the clear glass area and openness of the architectural design. Thresholds are recessed into the floor to give a frameless appearance. Handles are stylishly integrated into the profiles and further enhance the minimalist design.

Artline XL is available in a single-opening version with one or two sliding door leafs or a double-opening version with two sliding door leafs. Artline XL can be made up to 3.5 m in height and is also available as a 90° opening floating corner solution. Motorization is available as an option.

Elegant and exclusive designs for maximum light ingress and openness.



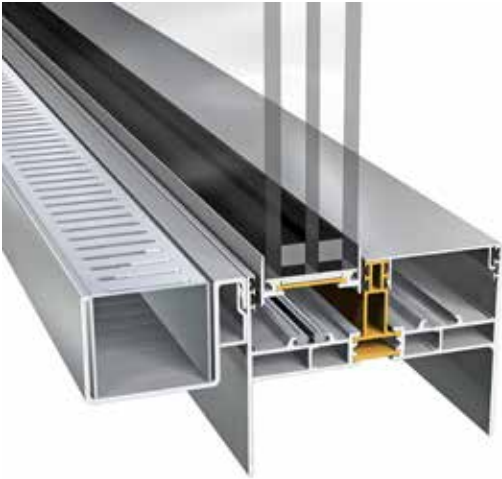

Sapa Sliding Door		Artline XL	
Glass thickness	triple-glazed: 40-52 mm		
Profile depth door leaf/frame	57/150 mm		
Door leaf max. dimensions	W 2800 mm. H 3500 mm (but height < 2.5 x width)		
Door leaf max. weight	500 kg		
Variants	Single- or double-opening Opening corner		
Fitting type	Espagnolette with 2 locking points Handle on inside		
Motorization	Yes		
Watertightness, class	Up to E750 (750 Pa) acc. EN 12208		
Airtightness, class	3 according to EN 12207		
Artline XL		U-value W/m ² K	
Glass	U _g = 0.5	U _g = 0.6	U _g = 0.7
W x H, 3000 x 2800 mm	U _w = 0.91	U _w = 1.0	U _w = 1.09
<i>Theoretical U-value calculation with allowance for glass, profile proportion and linear factors for edge zone effects according to EN 10077-1/2.</i>			



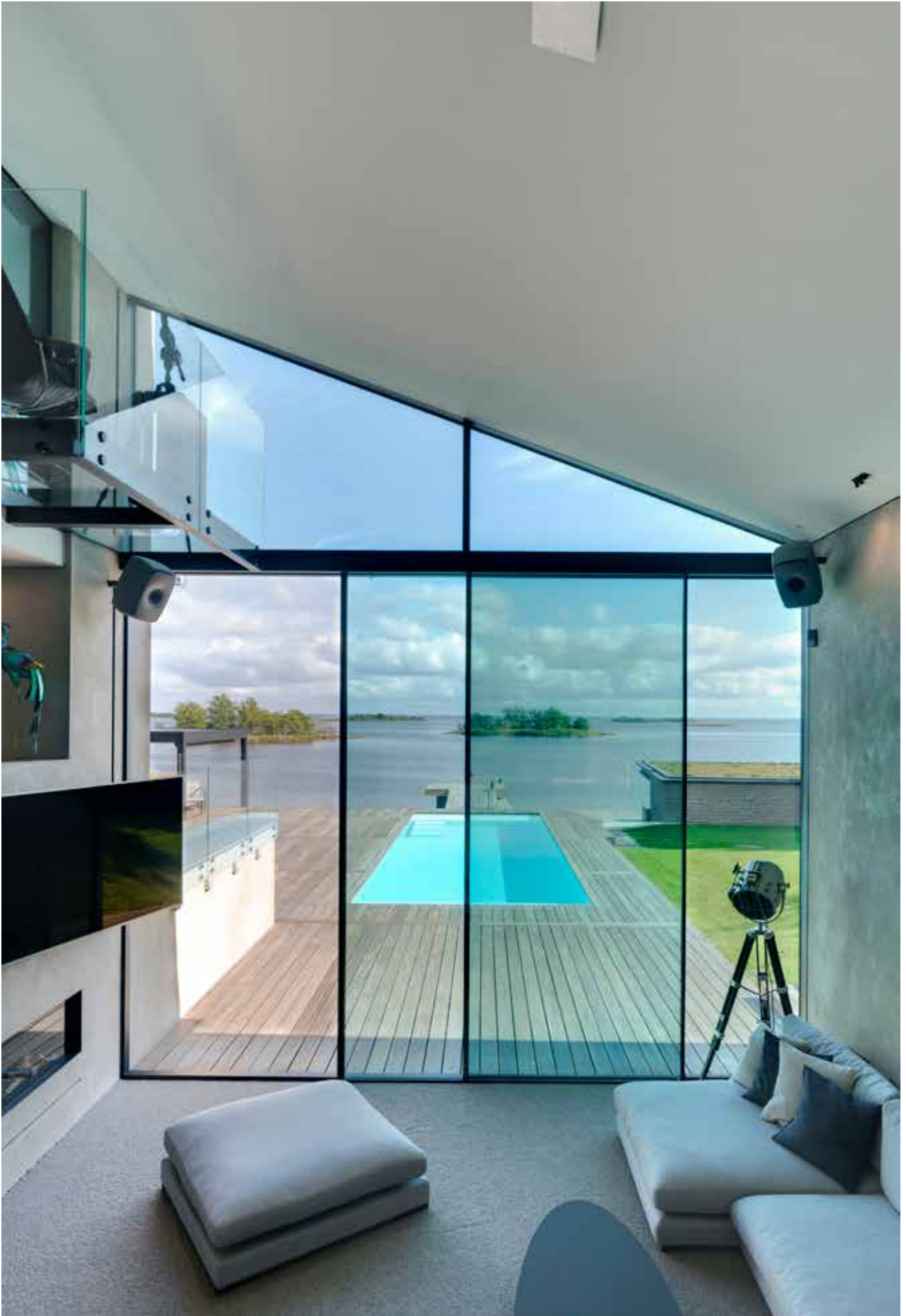

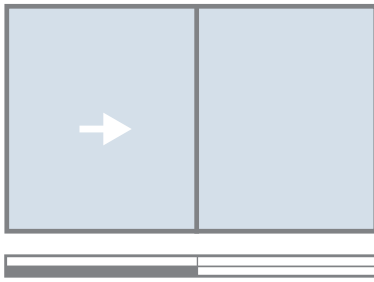

Single-opening with one sliding door leaf
(sliding door leaf outermost)

$$C.D. = F.O.D. / 2 - 136 \text{ mm}$$

$$F.O.D. = C.D. \times 2 + 272$$

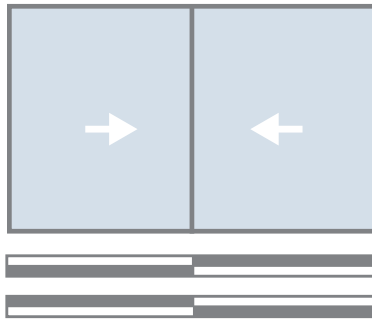

Single-opening with two sliding door leaves

$$C.D. = F.O.D. / 2 - 144 \text{ mm}$$

$$F.O.D. = C.D. \times 2 + 288$$

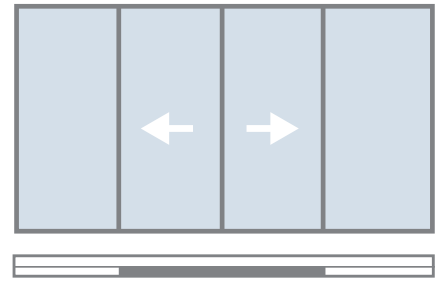

Double-opening with two sliding door leaves
(sliding door leaves outermost)

$$C.D. = F.O.D. / 2 - 203 \text{ mm}$$

$$F.O.D. = C.D. \times 2 + 406$$

Opening corner

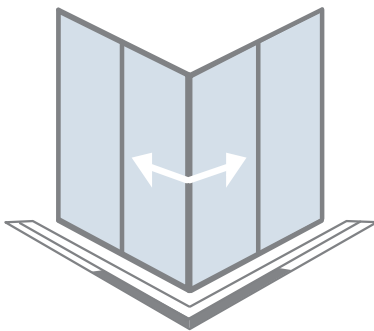

90° opening floating corner
(sliding door leaves outermost)

Glazing option triple-glazed

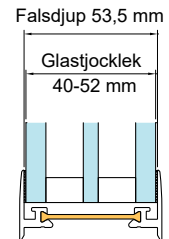

Profile section

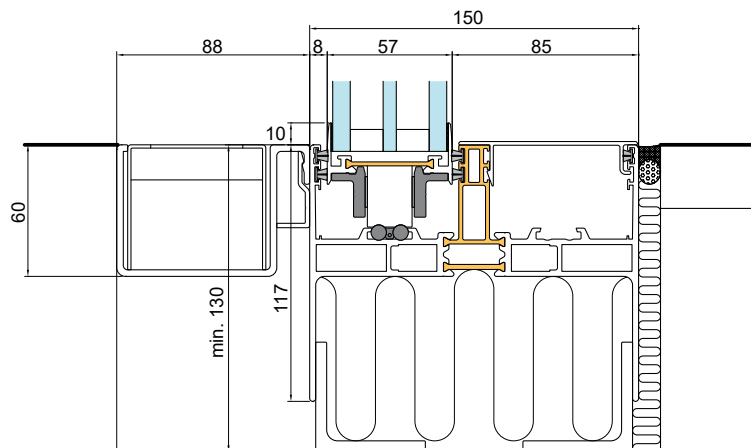

Profile section

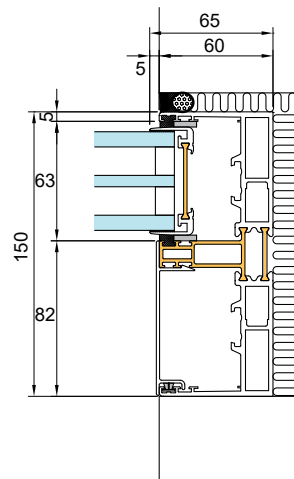
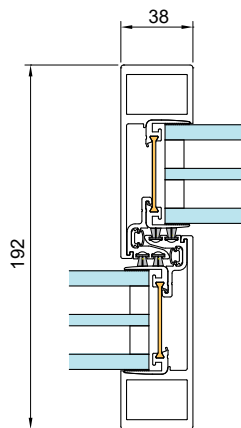
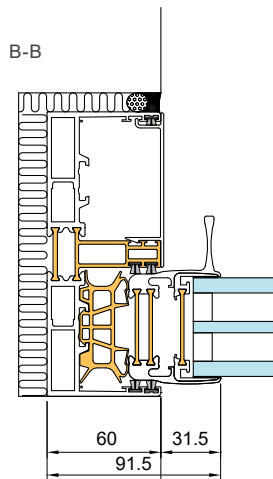
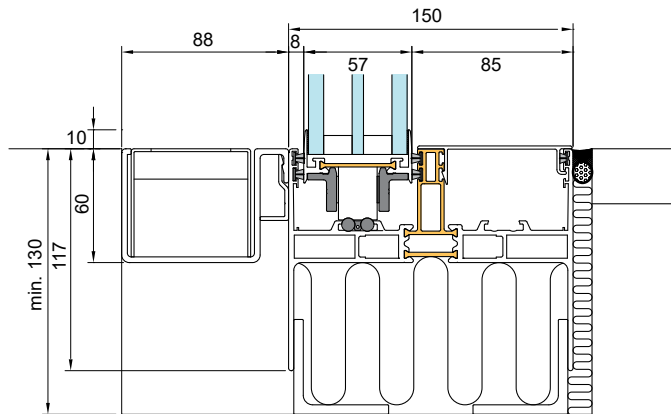
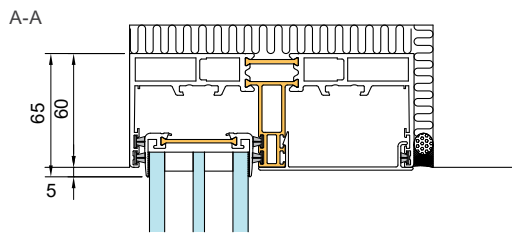
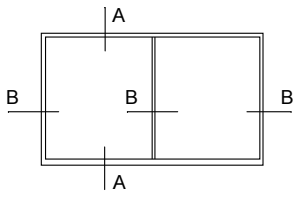

Profile sections, opening floating corner

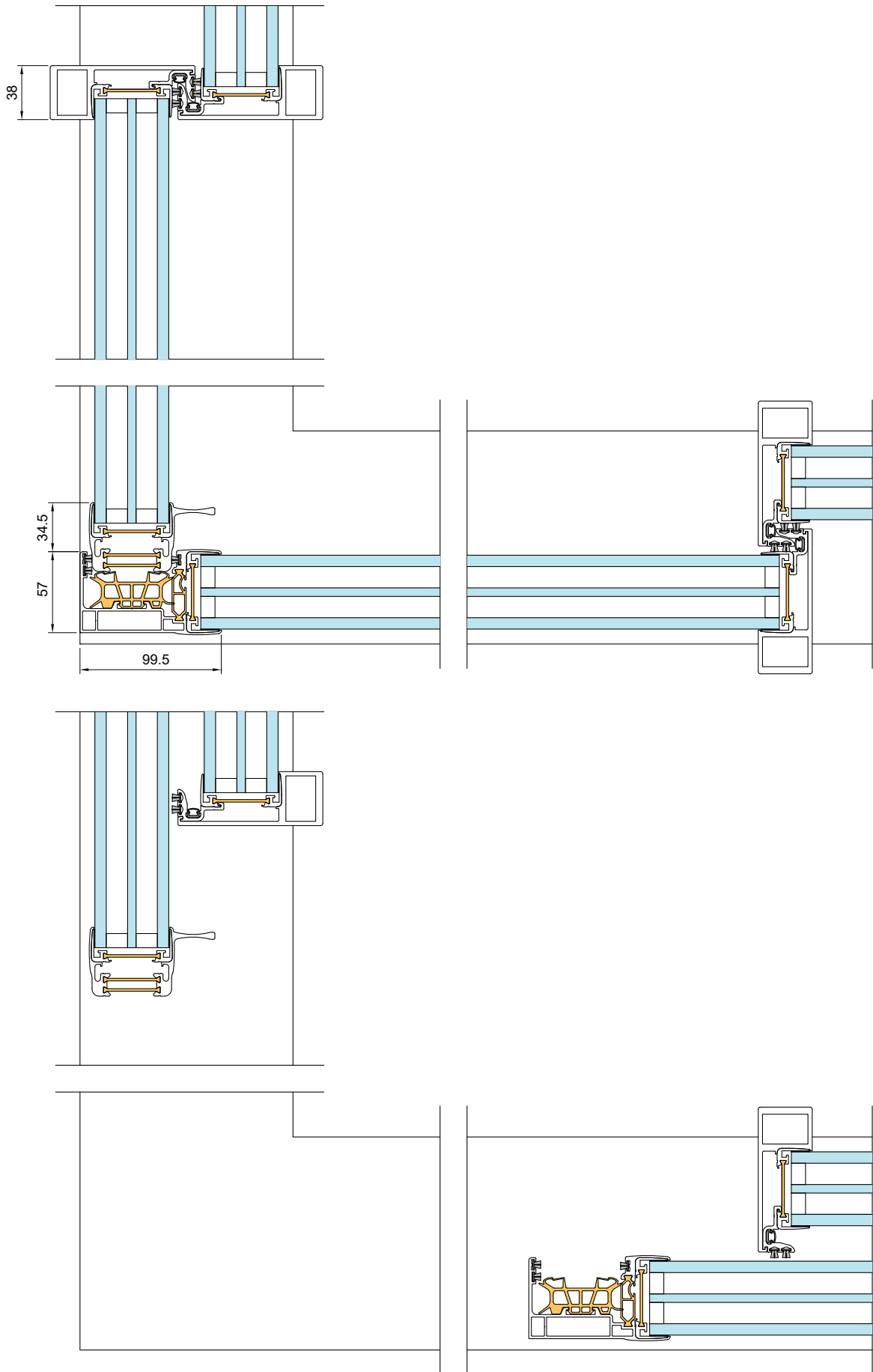

sapa:

By  **Hydro**

Hydro Building Systems, region North

Sweden

SE-574 81 Vetlanda
T +46 (0)383 942 00
E sapa.se@hydro.com

Norway

NO-2027 Kjeller
T +47 63 89 21 00
E sapa.no@hydro.com

Denmark

DK-8240 Risskov
T +45 8616 0019
E sapa.dk@hydro.com

Finland

FI-02180 Espoo
T +358 (0)9 867 82 80
E system.fi@hydro.com

Lithuania/Estonia/Latvia

LT-02244 Vilnius
T +370 (0)5 210 25 87
E sapa.lt@hydro.com

Poland

92-620 Łódź, Polska
T +48 (0)42 683 63 73
E sapa.pl@hydro.com

sapabuildingsystem.com